

NOTES:
1. Except where noted, a solid deck is not required for product shown on this page. Product is designed to hang from the countertop. Provide 6" x 6" clearance in rear corner of product cutout for gas connection.
2. Additional notch needed(L/R side) in countertop overhang to provide flush mounting of unit to island front face. -see illustration below
3. Additional notch needed(L/R side) in countertop overhang to provide flush mounting of unit to island front face. -see illustration below
4. If the island is designed using a backguard apron/backsplash, locate electrical service on the right hand side for connection of the rotisserie motor connection.
5. For Warming Drawer installation, provide accessible electrical outlet on right side of the warming drawer along rear interior wall of island.

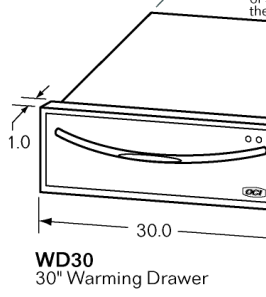

Insulated Jacket Specifications:

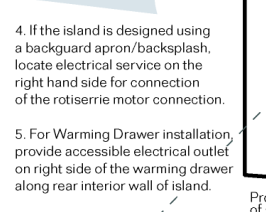
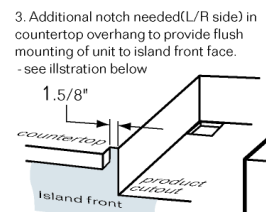
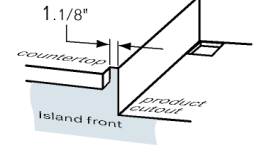
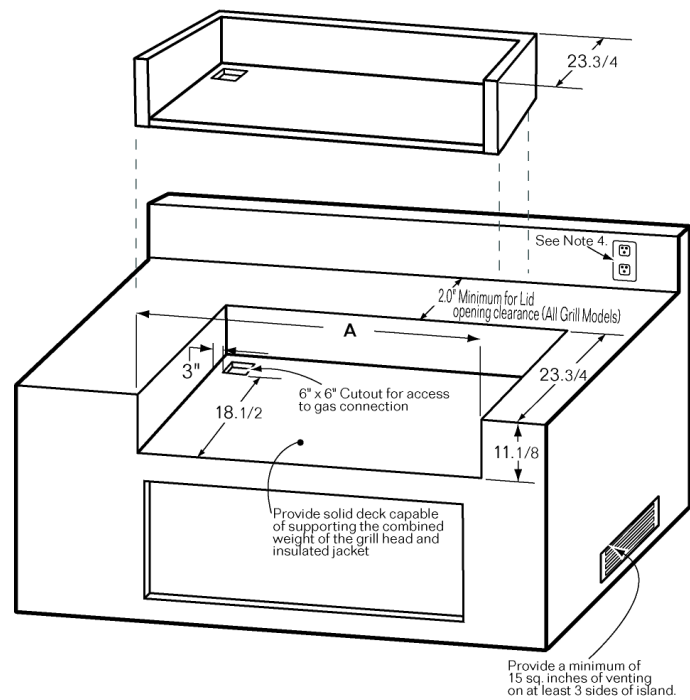

Overhead Heater Dimensions*:

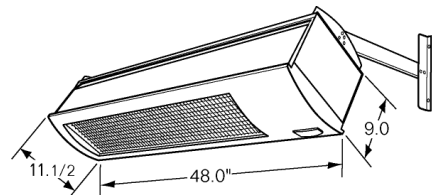

*Overhead Heater Planning:
1. Maintain proper clearances to combustibles when planning where the OCI Elite Overhead Heater is to be mounted. Refer to the installation guide and product specification sheet for detailed clearance and specifications.
2. Typical clearance to combustible or non-combustible material ranges from 12" to 24", depending on the installation location.
3. The OCI Overhead Heater is available in a LP or Nat. gas model.

Insulated Jacket Product / Cutout dimensions:

	A (cutout)
48 Grill model (E48IJ)	51.5/8
36 Grill model (E36IJ)	40.1/2
30 Grill model (E30IJ)	34.1/2
26 Grill model (E26IJ)	31.7/8

26" Grill cart represented above

30, 36, *30" Grill cart represented above

48" Grill cart represented above

Grill Cart dimensions:

Cart Notes:
* The 30 Grill cart model is equipped with 2 doors.
** The 26 Grill cart model is equipped with solid front and side panels. Access to the LP tank or other gas connection must be made from the rear of the cart. An additional 26 grill cart side shelf is available for order. (single side shelf for 26" grill part # E26SK)

	A	B	C	D(shelves up/folded down)	
48 Grill Cart(E48C)	50.3/4	45.1/4	48.0	81.0	56.0
36 Grill Cart(E36C)	38.3/4	34.1/4	36.0	69.0	44.0
* 30 Grill Cart(E30C)	32.3/4	28.1/4	30.0	63.0	38.0
** 26 Grill Cart(E26C)	n/a	26.0	26.0	39.7/8(fixed shelf)	n/a

Models:
E15SBBIL/BIN, E15IRB-BIL/BIN
(Dual Side Burner) (Dual Insta-Sear®)
A: 28.1/2" 27.1/2"

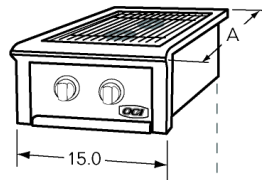

30" Combination Power Models:
E30DSL/N (Dual Insta-Sear®)
E30SBGL/N (Dual Side Burner + Grill)
E30SBIRL/N (Dual Side Burner + Insta-Sear®)

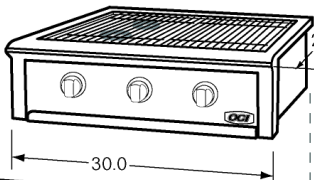

27CG-SS
27" Charcoal Grill

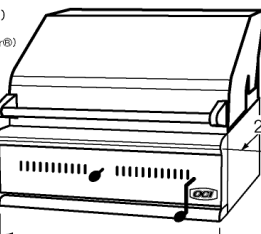

E26BQL/N
26" Grill

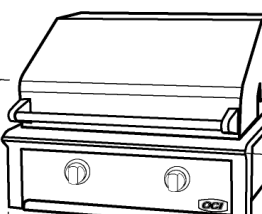

E30BQRL/N (30" Stainless Steel U-Burner Grill)
E30BQSRL/N (30" Dual Insta-Sear® Grill)



E36BQRL/N (36" Stainless Steel U-Burner Grill)
E36BQARL/N (36" Stainless Steel U-Burner + Insta-Sear® Grill)

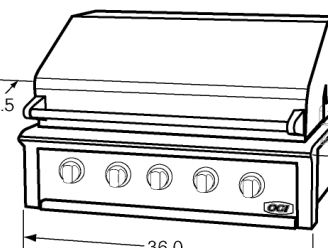

E48BQRL/N (48" Stainless Steel U-Burner Grill)
E48BQARL/N (48" Stainless Steel U-Burner + Insta-Sear® Grill)

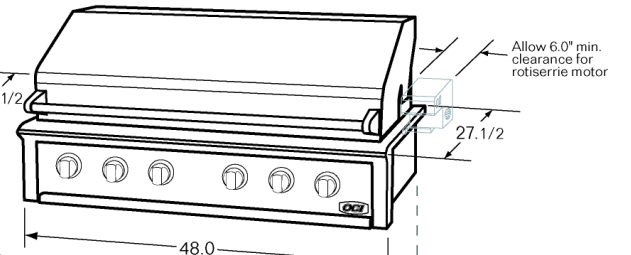

All dimensions shown are for product planning purposes. Please consult the individual product installation instructions for detailed product cutout and specifications and requirements prior to committing materials for product installation.

NOTES:
1. Provide 6" x 6" clearance centered for routing of drain.
2. Additional notch needed(L/R side) in countertop overhang to provide flush mounting of unit to island front face.
-see illustration below

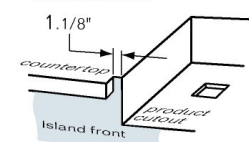

3. Additional notch needed(L/R side) in countertop overhang to provide flush mounting of unit to island front face.
-see illustration below

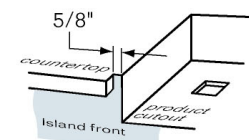

4. Except where noted, a solid deck below product is not required.
Product is designed to hang from the countertop.

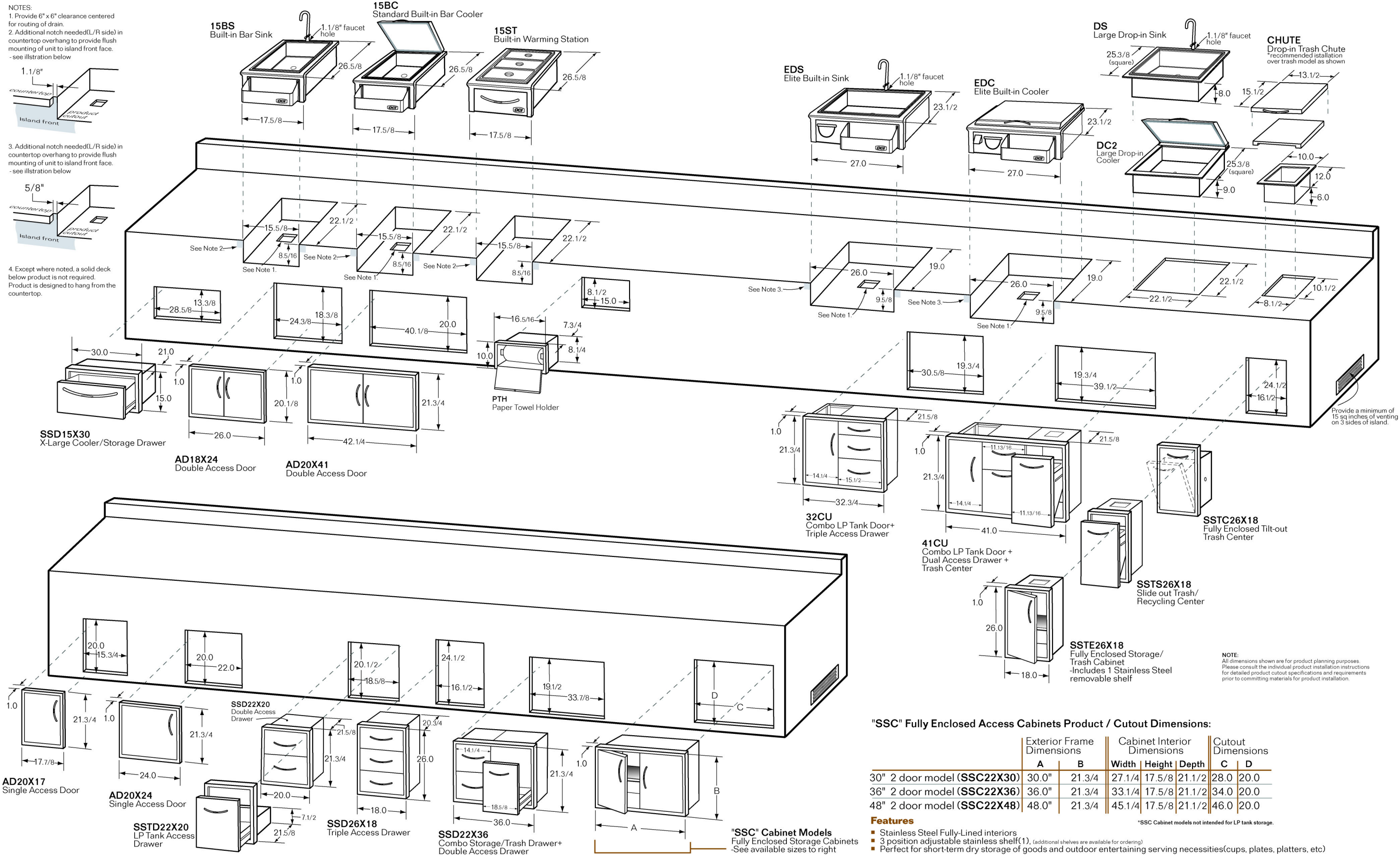

"SSC" Fully Enclosed Access Cabinets Product / Cutout Dimensions:

	Exterior Frame Dimensions		Cabinet Interior Dimensions			Cutout Dimensions	
	A	B	Width	Height	Depth	C	D
30" 2 door model (SSC22X30)	30.0"	21.3/4	27.1/4	17.5/8	21.1/2	28.0	20.0
36" 2 door model (SSC22X36)	36.0"	21.3/4	33.1/4	17.5/8	21.1/2	34.0	20.0
48" 2 door model (SSC22X48)	48.0"	21.3/4	45.1/4	17.5/8	21.1/2	46.0	20.0

Features

- Stainless Steel Fully-Lined interiors.
- 3 position adjustable stainless shelf(1), (additional shelves are available for ordering)
- Perfect for short-term dry storage of goods and outdoor entertaining serving necessities(cups, plates, platters, etc)

*SSC Cabinet models not intended for LP tank storage.