

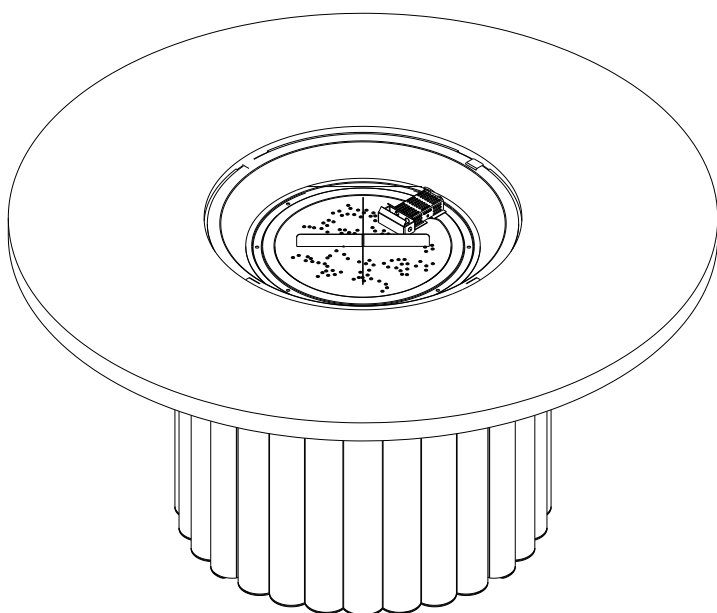

Reverie Fire Pit Table

Owners Manual



IMPORTANT

Consult your Crystal Fire® Plus Burner User manual for detailed instructions and important information regarding burner installation including: full burner setup, lighting instructions, safety information, and proper tightening of connections.

DO NOT ATTEMPT TO INSTALL CRYSTAL FIRE® PLUS BURNER WITHOUT FIRST CONSULTING THE CRYSTAL FIRE® PLUS BURNER USER MANUAL

Contents

A. Required Tools.....	3
B. Included Items.....	3
C. Placing & Assembling the Fire Table.....	4
D. Burner Installation.....	5
E. Installing Propane Tank.....	7
F. Finishing Touches.....	8
G. Care & Maintenance.....	10
H. Service Parts.....	11
I. Warranty Information.....	12

A. Required Tools



Utility Knife - Cut and remove packaging



Phillips Screwdriver - Attach top and valve to base



Gloves - Protect hands from rough edges



One (1) AAA Battery (Not Included) - Required for spark igniter installation and operation



For Supercast Tops:

TEAM LIFT: Do not attempt to perform installation by yourself. Have at least one other person available to help you.

B. Included Items

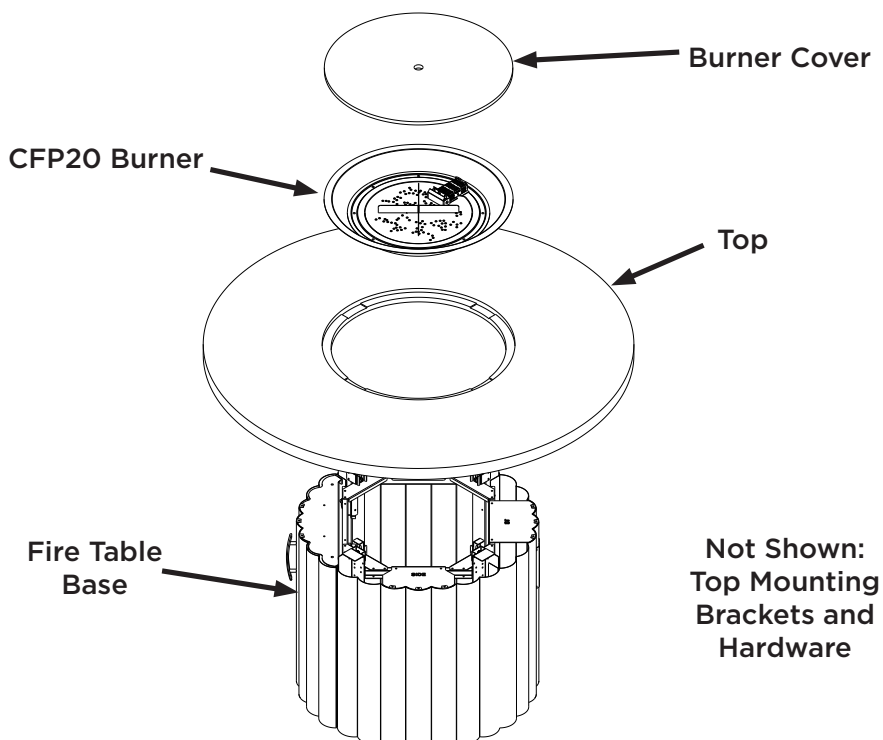

C. Placing & Assembling the fire table

1. Remove all components from packaging.
2. Move the fire table base to desired location, on solid ground. Do not place on grass or dirt. **Refer to Crystal Fire® Plus Burner user manual to ensure clearances to combustible materials are met.**
3. If necessary, adjust leveling feet at the bottom of the base. This will allow the tank tray to move smoothly.
4. Position Supercast top on the base. Ensure the burner opening is centered on base opening, and indents on top line up with legs on base.

Supercast Mounting Bracket

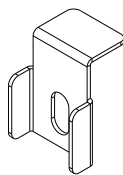

5. Secure Supercast top to base using four (4) included brackets and four (4) machine screws.

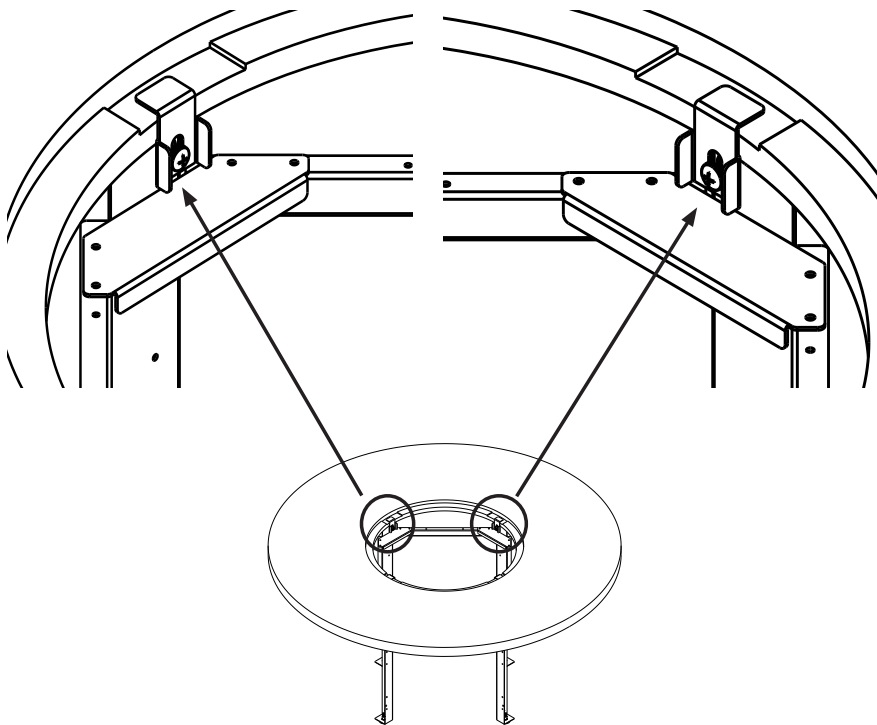

D. Burner Installation

READ THE CRYSTAL FIRE® PLUS INSTALLATION MANUAL BEFORE BEGINNING BURNER HOOKUP OR OPERATING THE FIRE PIT



Crystal Fire® Plus
Installation Video

1. Rest burner on top using cardboard packaging to protect surface.

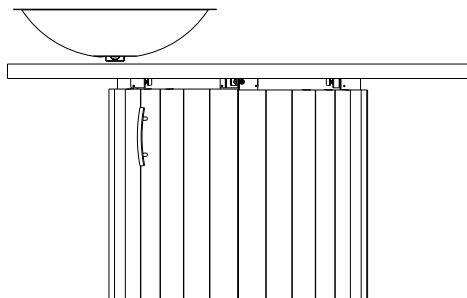

2. Connect orange ignitor wire and black ground wire to the terminals on the back of the sparker. Both wires can be connected to either location.
3. Remove sparker cap and hex nut from the sparker. See Figure D.1.

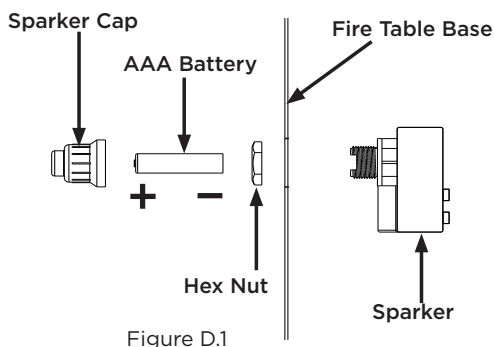

Figure D.1

4. Install sparker into control panel of fire table base. Tighten hex nut onto sparker to secure to base.
5. Insert AAA battery (not included) with the positive (+) end oriented outward. Secure sparker cap onto sparker.

D. Burner Installation

6. Test the spark ignition by pressing the sparker and looking for a spark on the burner between the two pieces of metal. Consult the troubleshooting section of the Crystal Fire® Plus burner user manual if the spark is weak, intermittent, or not present. See Figure D.2.

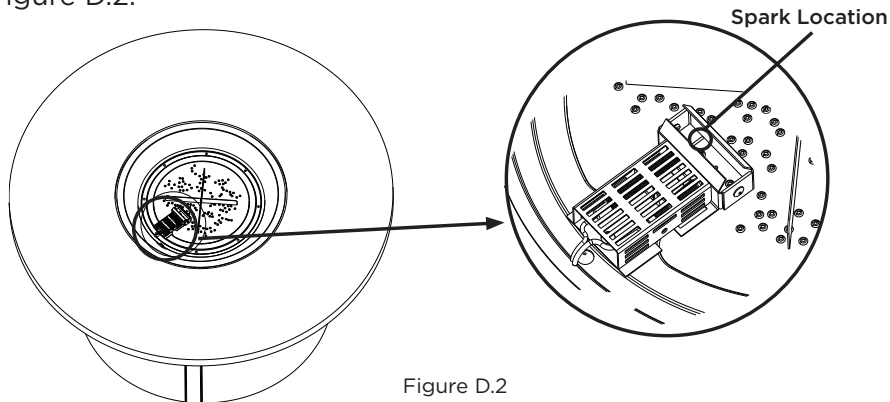

Figure D.2

7. Thread 1 burner screw a couple of threads into the bottom the burner control valve. See Figure D.3.

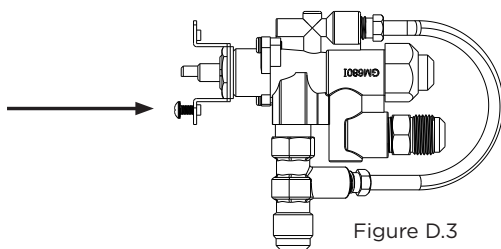

Figure D.3

8. Line up valve screw into tear drop hole, and lower into place. Tighten screw, then add second screw into top hole. Secure knob to valve stem. **Sparker must be installed before valve.** See Figure D.4

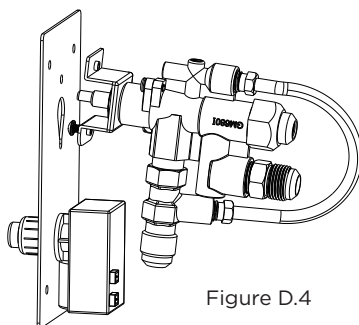

Figure D.4

E. Installing Propane Tank

1. Lift off the access door of base and set aside. Pull out tank tray. See Figure E.1.

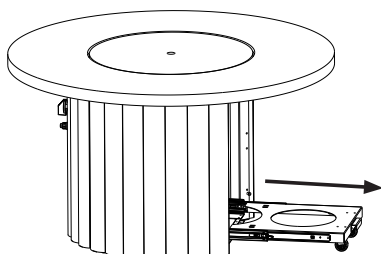

Figure E.1

2. Set 20 lb. liquid propane tank in tray and ensure it is fully seated in the tray. See Figure E.2.

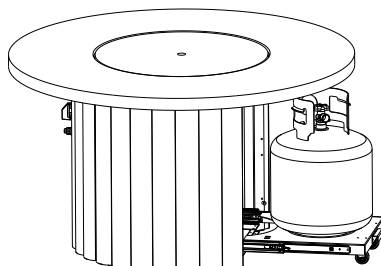

Figure E.2

3. Make sure the propane tank valve and burner control valve are both in the "OFF" position, connect regulator hose to the propane tank. **Hand-tighten this connection. DO NOT USE TOOLS FOR THIS STEP.** See Figure E.3.

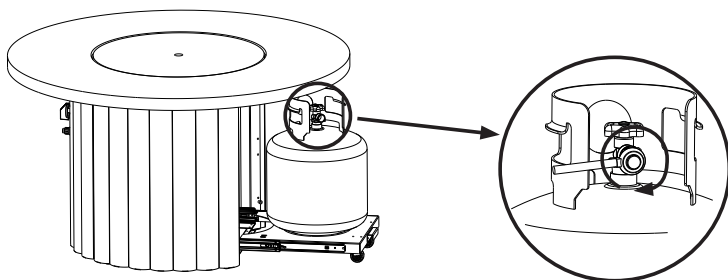

Figure E.3

E. Installing Propane Tank Continued

4. Secure excess regulator hose to hook-and-loop strap on tank tray. Slide tank tray back into base. Ensure hose is not pinched by the tray or against bottom of burner. See Figure E.4.

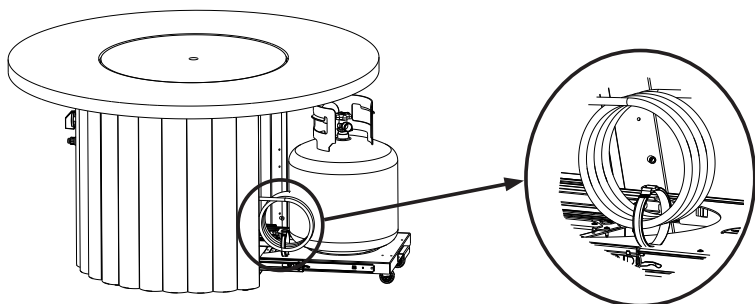

Figure E.4

F. Finishing Touches

1. Install Outdoor GreatRoom Company approved burner media according to Crystal Fire® Plus burner user manual. **DO NOT BURN FIRE TABLE WITHOUT BURNER MEDIA.**
2. Save all user manuals and product documentation, stored away from the unit.
3. Recycle all cardboard packaging.

WARNING

After consulting the Crystal Fire® Plus user manual and following instructions,

CHECK ALL GAS CONNECTIONS FOR LEAKS BEFORE OPERATING.

IMPORTANT

Consult your Crystal Fire® Plus burner user manual for detailed instructions and important information regarding burner installation including: full burner setup, lighting instructions, safety information, and proper tightening of connections with two wrenches

DO NOT ATTEMPT TO INSTALL CRYSTAL FIRE® PLUS BURNER WITHOUT FIRST CONSULTING THE CRYSTAL FIRE® PLUS BURNER USER MANUAL



WARNING: This product can expose you to chemicals including Carbon Monoxide and Benzene which are known to the State of California to cause cancer or birth defects or reproductive harm. For more information, visit www.P65Warnings.ca.gov

G. Care & Maintenance

Top

It is recommended that all tabletops be covered when not in use to protect the top and burner. The Outdoor GreatRoom Company offers optional protective covers for all products.

It is recommended to reseal the Supercast top annually using a solvent-based sealer. This sealer (SC-Sealer) is available through The Outdoor GreatRoom Company. Contact your local dealer or visit outdoorrooms.com.

Fire Table Base

Dust, dirt, and debris can be removed utilizing water and a mild dish soap solution. Dry base with a lint-free towel or paper towels when necessary. Touch-up paint is available for small chips or scratches. Contact your local dealer or visit outdoorrooms.com.

Tank Drawer Slides

In the event that the drawer slides begin to stick during operation, an aerosol lubricant like WD40® or equivalent can be sprayed on the bearings. This can be performed as needed, or as a part of annual maintenance of the fire table. Spray the lubricant on the drawer slide bearings and open and close the tank tray 5-7 times.

CFP20 Burner

Refer to Crystal Fire® Plus burner user manual for all burner related care and maintenance. Annual maintenance of the burner is required for continued proper operation.

H. Service Parts

Refer to Crystal Fire® Plus Burner user manual for all burner-related service parts.

Part	42" Top	48" Top
Base: <ul style="list-style-type: none"> • Black • Brown • Charcoal • White 	REV-BASE-BL REV-BASE-BR REV-BASE-CH REV-BASE-WH	
Door <ul style="list-style-type: none"> • Black • Brown • Charcoal • White 	3013-023-BL 3013-023-BR 3013-023-CH 3013-023-WH	
Drawer slides	3000-737SRV	
Supercast Top (& Cover) <ul style="list-style-type: none"> • Smokey Oak • Relic Grey • Fossil Brown 	3010-064 3010-063 3010-061	N/A 3010-062 3010-060
Supercast Cover <ul style="list-style-type: none"> • Smokey Oak • Relic Grey • Fossil Brown 	3010-349SRV 3010-347SRV 3010-346SRV	
Supercast Sealer	SC-SEALER	

I. Warranty Information

Warranty:

Fire pit tables are covered under a 3-year manufacturer's warranty. Please visit <https://www.outdoorrooms.com/product-registration> to register your product.



Thank you for purchasing an Outdoor GreatRoom Company product! This fire pit was assembled with pride in the USA with US & imported parts.



9853 217th St. W, Lakeville, MN 55044

Toll Free: 1-866-303-4028 | sales@outdoorrooms.com