

# Alfresco<sup>TM</sup>

Open Air Culinary Systems



## AR-24 CONTROLLER QUICK GUIDE

## CONTROLLER QUICK GUIDE

Your Alfresco AR-24 refrigerator comes preconfigured from the factory for operation upon plugging the unit to an 115 VAC outlet (GFCI preferred).

The controller display is located on the interior back wall of the refrigerator just above the top shelf.

The controller display is touch sensitive and it is used to:

- Turn Refrigeration **ON** and **OFF**
- Adjust Temperatures.
- Time and Date.
- Light Brightness and Color

The controller has a rechargeable backup battery for information pertaining to your preferred settings as the ones described above.

If the refrigerator is unplugged from the power line, it will of course stop working.

If the refrigeration was turned **ON**, when unplugged (or during a power loss), the refrigerator will re-start with the previous settings it was working with, when the refrigerator is plugged back in or power is restored.

If the refrigerator was powered but refrigeration was turned **OFF**, the refrigerator will return to this same mode if power is lost and restored.

Please note that if the unit is unplugged for more than 48 hrs., the date and time settings will be reset, but all other settings such as refrigeration ON / OFF, temperature, light color and brightness will be restored.

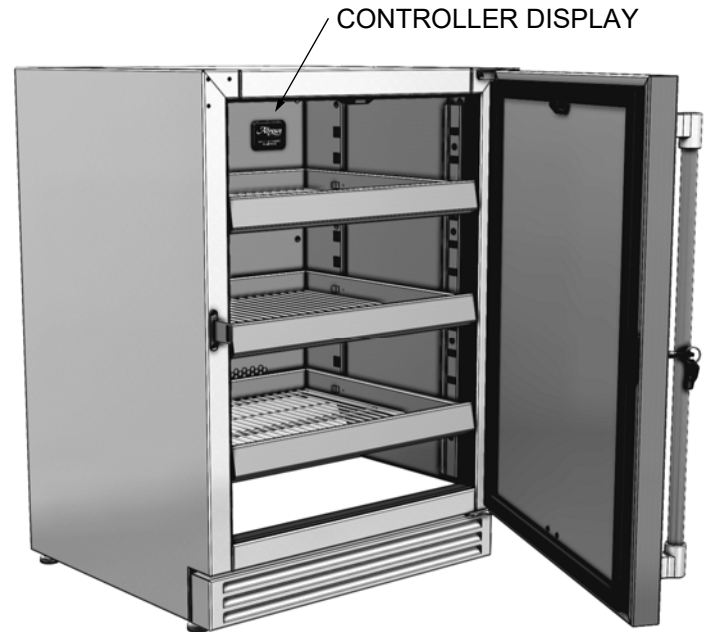

## CONTROLS

Upon powering the system up by plugging the unit, the display will start initializing with a black screen and immediately go to the BOOT screen.



### BOOT SCREEN

The controller is starting up and a circle with small dots flashes as the system initializes. This process takes about 10 ~ 20 seconds.

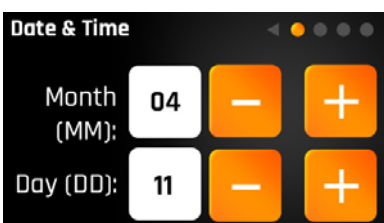

### DATE & TIME SCREEN

Enter the Month (MM) and Day (DD).

This information is required as the refrigerator controller records all working parameters and conditions of the refrigeration system with a proper timestamp.

**TIP:** Note on the display that the upper right corner of the screen indicates the number of screens that are available to scroll through by swiping left or right. Each available screen is indicated by a grey dot and the orange dot represents the screen in view.

When an arrow is displayed on the corner next to the series of dots, it will indicate the direction that it is required to swipe in order to exit the selection screens.

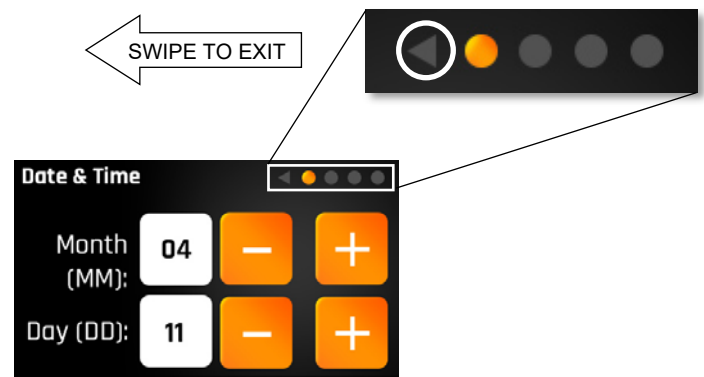

After the initial date and time setup is completed, if the user swipes or selects any menu item but does not complete the task, the menu will revert back to the previous screen.

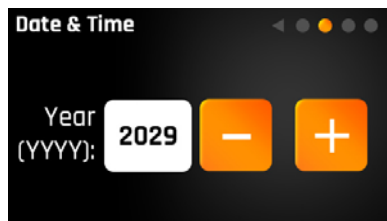

### YEAR

Select the year.

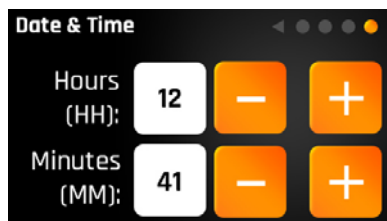

### TIME & MINUTES

Select the current time by number (12 Hr).

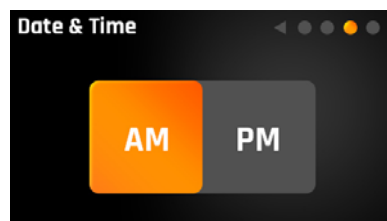

### AM / PM

Select AM / PM by toggling between then highlighted item is orange.

► You can now swipe left to exit this initial setup.

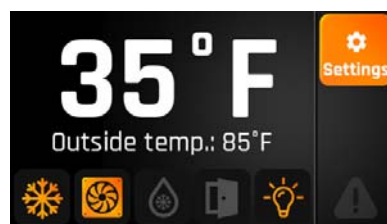

The refrigerator controller will now start the unit, lights will come on and the refrigerator will start cooling the unit.

Initially and after every power on/off cycle (loss of power or setting the refrigeration system OFF) will delay the start up sequence of the compressor for 2 minutes. The compressor will start after this delay period.

## DISPLAY SYMBOLS AND MEANING

Once the refrigeration system is running, the display will show the following icons:

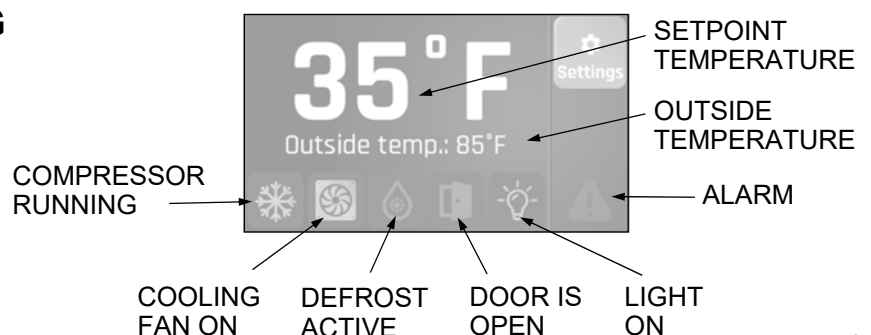

## CHANGING SETTINGS: (SETTINGS MENU # 1)

From the main running screen previously shown , you can now access all settings by pressing the settings button on the upper right corner:

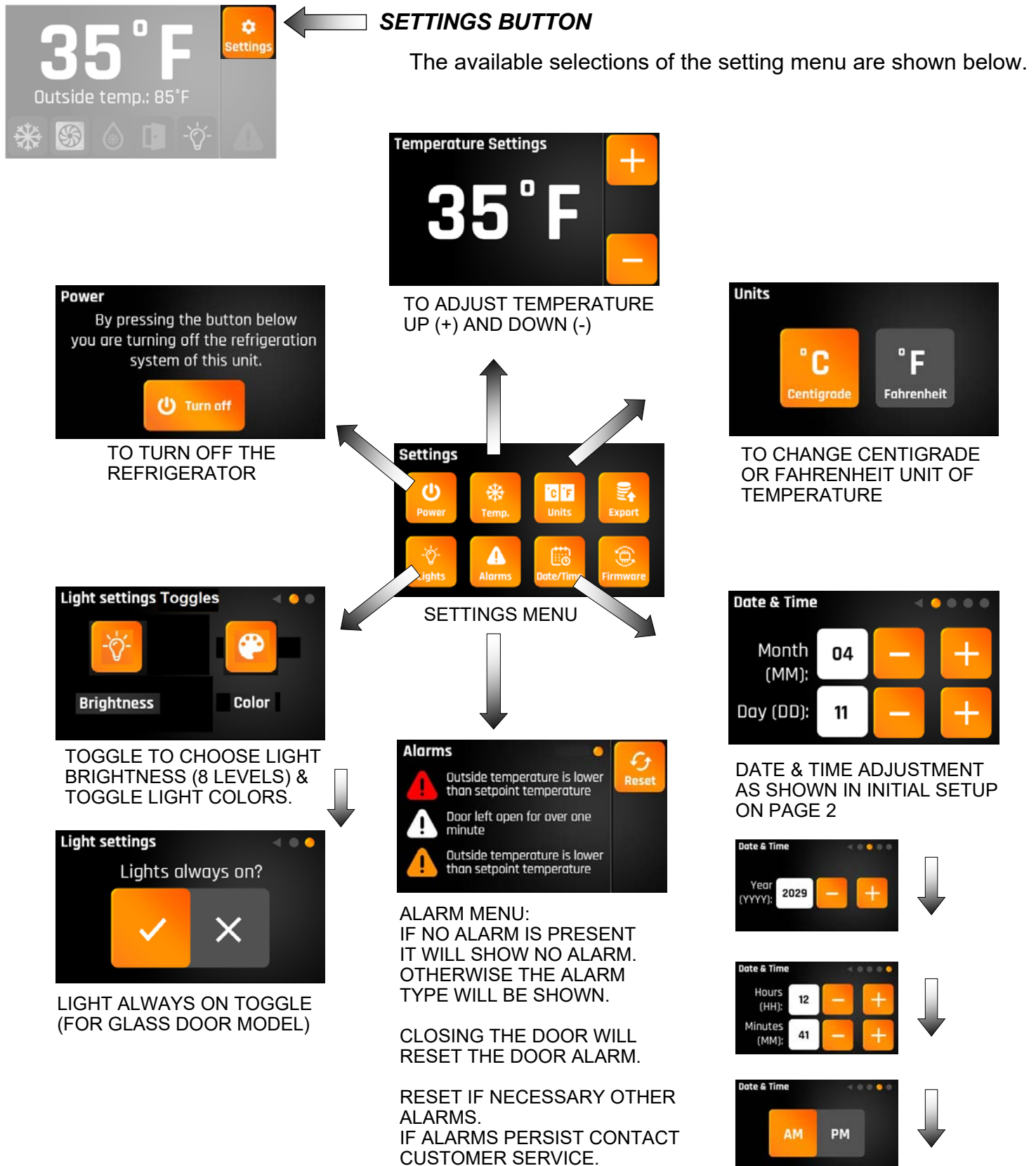

**NOTE:**

When the refrigerator is manually turned OFF, the unit will revert to the START Screen shown below.

To restart the refrigerator cooling, swipe left or right. The refrigerator will now start with the last temperature setting that was running previously setup with.

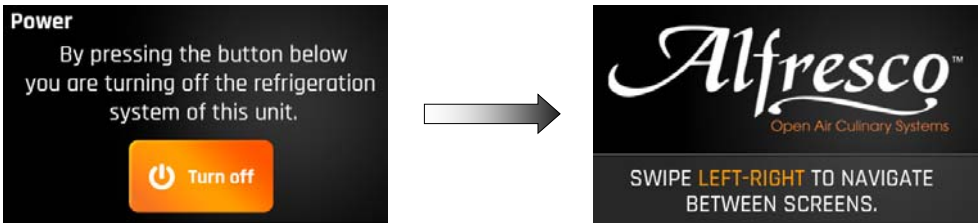

**CHANGING SETTINGS: (CONT.)**

Export and Firmware updates are meant for troubleshooting the refrigerator and allows to download running conditions information and data as well as to update the controller software if required.

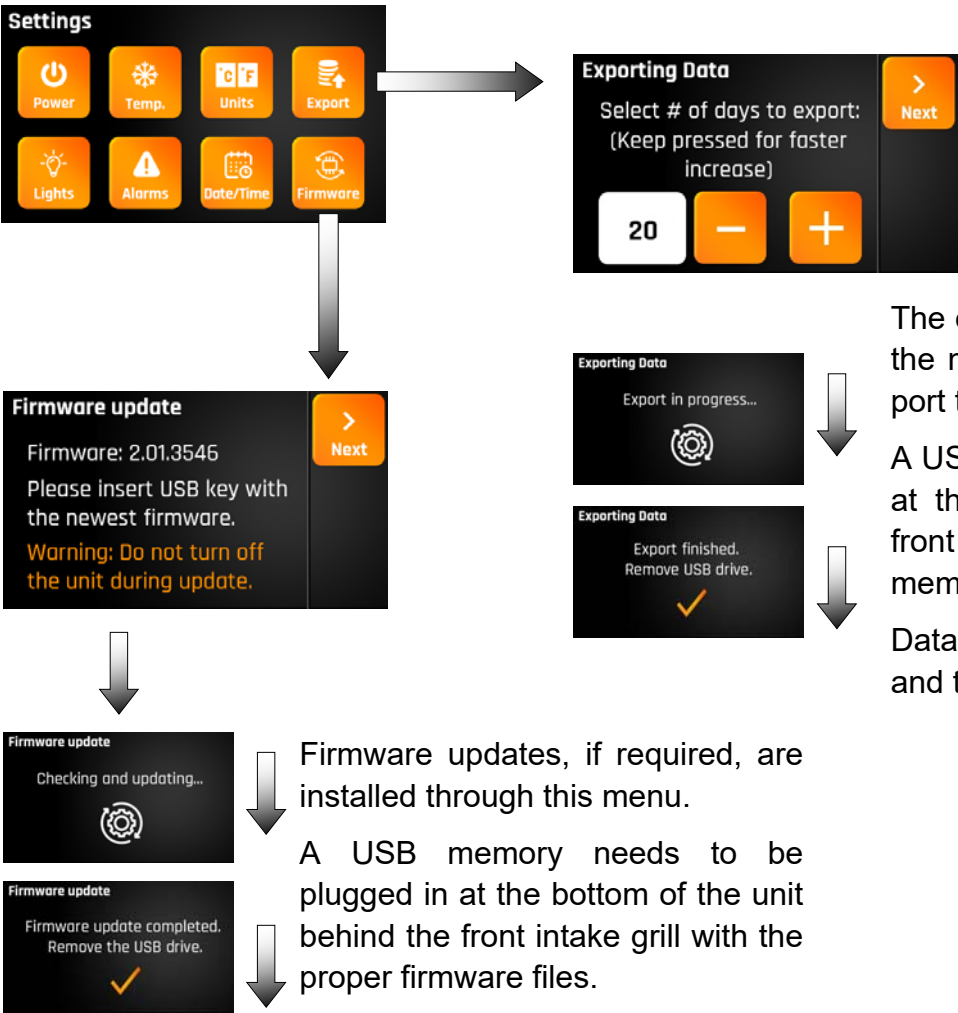

The exporting of data requires to select the number of days is required for export to a USB memory.

A USB memory needs to be plugged in at the bottom of the unit behind the front intake grill. All data in the USB memory will be erased before export.

Data exported is solely for factory use and troubleshooting

Firmware updates, if required, are installed through this menu.

A USB memory needs to be plugged in at the bottom of the unit behind the front intake grill with the proper firmware files.

This is only to be used for service.