



Drop in Induction Cooktop – Install Quick Specs CTI 30" Wide

Installation Type

Drop into countertop opening

Cooktop Carton Weight:

CTI304D = 45 lbs.

Overall & Cutout Dimension(s)

CTI304D	A	B	C
Overall	30"	21"	2 5/8"
	D	E	
Cutout	29 3/8"	19 3/4"	



LISTED 90ZK C



Standard Features

- Low-profile, ceramic glass, with matching rear frame.
- Textured glass surface helps minimize fingerprints and protects the glass finish.
- 30" Model (CTI304D) features four cooking zones. Total cooktop power of 7,200 watts.
- Precise, touch-sensitive electronic controls with 11 power settings (includes 3 pre-set options)
- Full range of power on all zones. NO power sharing or cycling between zones.
- AutoPanSizing™ feature senses pan size, then matches heat transfer to the pan – *no residual heat loss**
- Most energy efficient cooking method which equates to lower energy costs and cooler kitchens.
- AutoOff™ feature that will turn the cooking surface off within 30 seconds, if pan is removed or it senses a non-conductive pan is present.
- Cool to-the-touch cooking surface – safest cooking method to use around children.
- Shallow rough-in box depth for extra cabinet storage.

*Not sure if your pans will work on induction? Place a magnet on the bottom, if it sticks, it will work!

Finishes

- Elegantly textured black ceramic glass with matching rear frame.

Maximum Power Supply Required

40 Amps @ 208/240 V AC, 3-wire, 60Hz, single phase connection. 4-foot, three-wire, flexible conduit comes with cooktop. Conduit is located off the center rear of the cooktop.

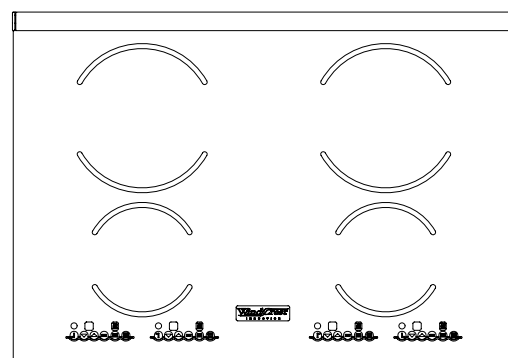
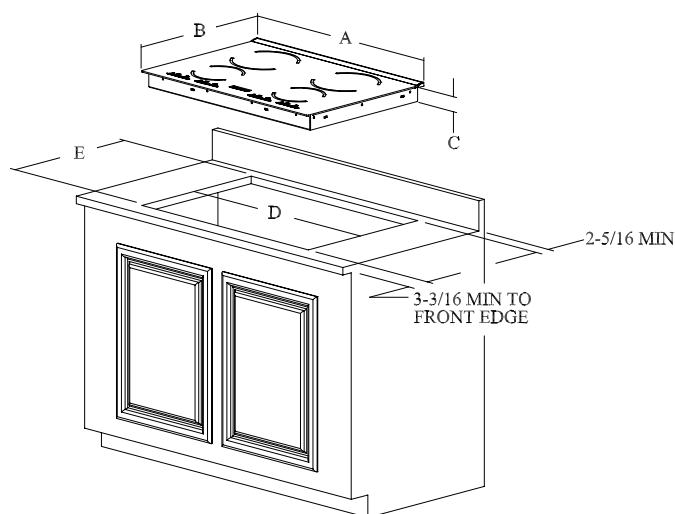

CTI304D features Two 6" (2200 Watt) and Two 9" (2600 Watt) Induction Zones