



Smart, Bluetooth®
Grilling & Smoking Thermometer

DETAILED USER GUIDE



GrillEye® DEVICE

P.01 Getting to know your GrillEye® device

P.02 Preparing the GrillEye® for use



GrillEye® PROBE

P.03 Using your GrillEye® probes



GrillEye® APP

P.04 App overview - system requirements

P.05 Setting the temperature to °C or °F

P.06 How to enable/disable alarm sounds

P.07 How to create a range preset

P.08 How to create a peak preset

P.09 How to edit/delete a preset

Safety notes

P.10 General notes

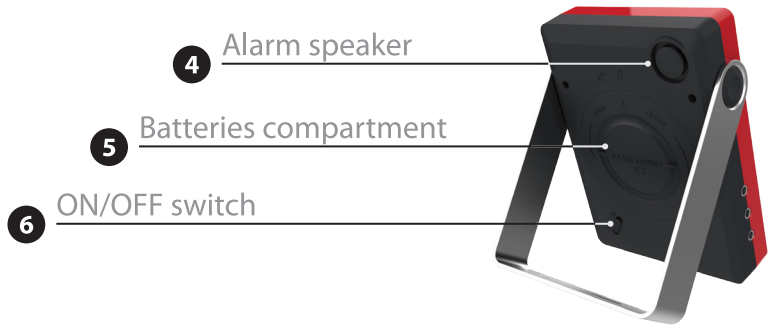

Range of 100m / 300ft*
*measured in open field without obstacles



Weather resistant*
*withstands humidity up to the point it doesn't create water condensations on the device

- 1** Peel-off screen protector
enable better view of your GrillEye LED screen



- 2** Insert batteries
2x AA batteries included

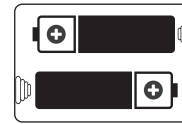

Make sure to place the batteries as shown



Battery life:
~168+ hrs*

* Battery life may vary based on use
(e.g. number of probes connected etc.)

- 3** Power on the device
Slide the power switch

Slide the switch to ON position.



The EYE will light up and a white LED will start blinking, indicating the device is ready to pair.



LED INDICATORS EXPLAINED

- Green : waiting for connection (not paired)
- White : ready to pair (pairing request received from app)
- Blue : connected to app (exchanging data with app)
- Red : device in alarm (temp. or disconnection)

⚡ For powersaving purposes, the device will power off automatically if idle for more than 4'.
To wake, press main button (pairing) for 3".

1 Prepare your GrillEye® Probe Pro-grade meat & ambient thermometer



Caution!

Grip may become hot while in use

A

Remove probe wrap

Make sure to remove before use by unfolding wire

B

Insert in meat

Use the probe to monitor meat temperature while grilling

Attach to grill

The probe clip allows you to get ambient temperature readings

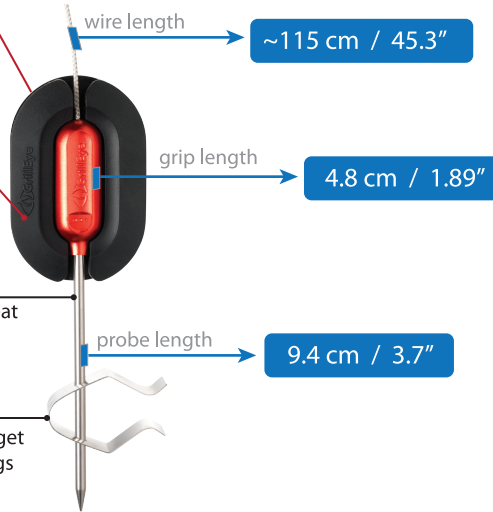

2 Connect the probe to the GrillEye® Insert the 2.5mm jack to any available port



Approved by the FDA for safe use with food

Water resistant for care-free use and cleaning



Probe range: - 50 to 300 °C
- 122 to 572 °F

Accuracy: ± 1 °C
± 1.8 °F

Max. Tolerance: 380 °C
716 °F

Download the GrillEye® app
Available for iOS & Android



System Requirements



Bluetooth® Smart v.4.2 or later



iPad Mini™, iPad® 3 and later, iPhone® 4S and later, iPod touch® 5th gen and later.



Android™ phones running 4.3 or later.

STEP 1

Select →

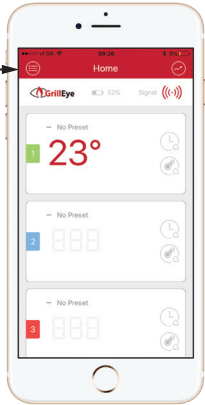

STEP 2

Select →

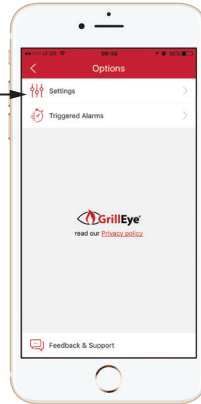

STEP 3

Select the preferred unit of measurement for the temperature*

*changes will be reflected automatically to both the app as well as your GrillEye® display



STEP 1

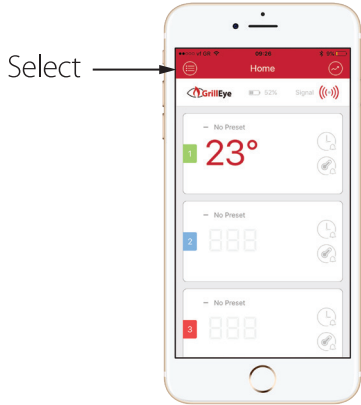

STEP 2

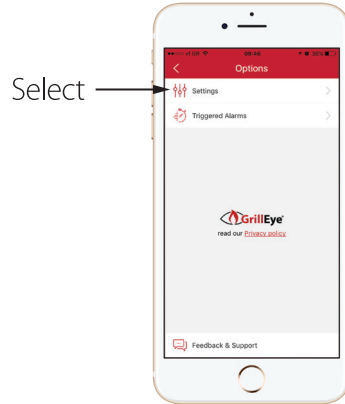

STEP 3

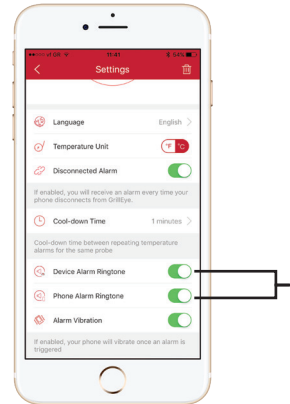

These 2 options allow you to control GrillEye® alarm notifications.

- Upper option: mutes the GrillEye®
- Lower option: mutes your mobile

STEP 1

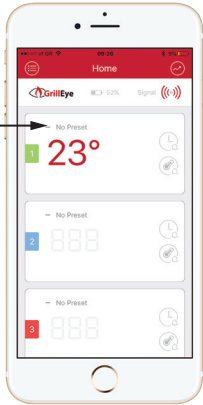

Select →

STEP 2

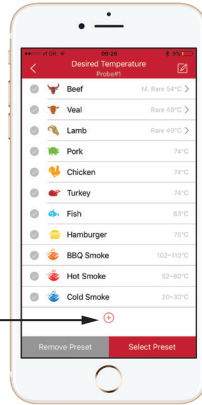

Select →

STEP 3

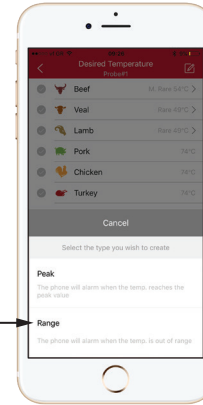

Select →

STEP 4

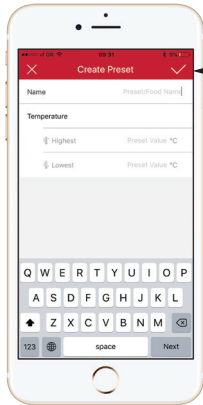

When you finish select to save

Fill-in the upper and lower temperature of your preference

STEP 5

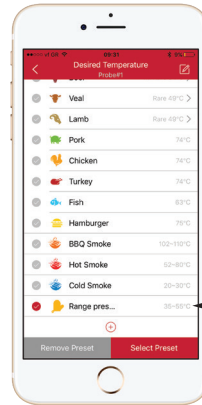

Your preset is READY!

STEP 1

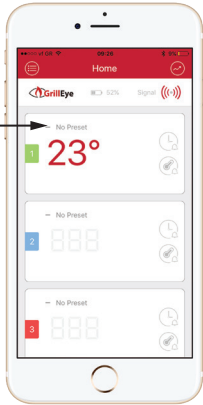

STEP 2

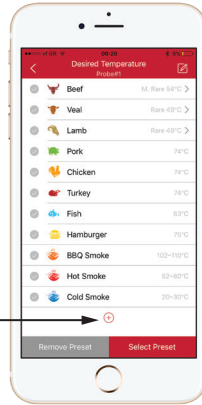

STEP 3

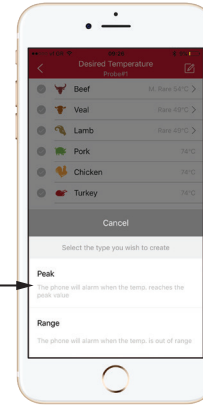

STEP 4

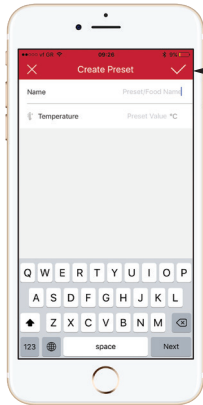

When you finish select to save

Fill-in the desired temperature

STEP 5

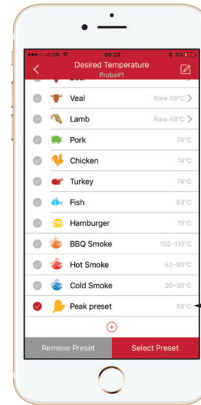

Your preset is READY!

STEP 1

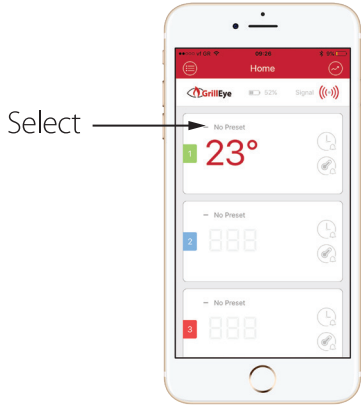

STEP 2



STEP 3

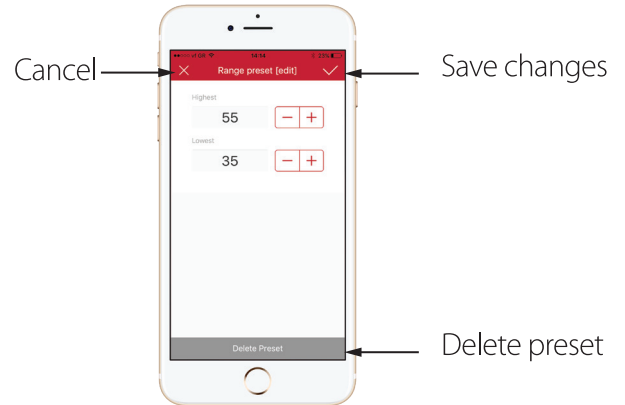





Safety instructions

Use and maintenance



GrillEye® Meat Probe & Ambient Clip



-  Caution! Grip may become hot while in use.
-  Do not expose directly onto fire.
-  Keep away from children.
-  Do not submerge under water. Not dishwasher safe.
-  Do not overfold/break wire.

GrillEye® Smart Grilling Device



-  Avoid prolonged exposure to heat.
-  Do not attempt to open or modify.
-  Requires a **Bluetooth® Smart** enabled device

General Provisions

G&C Ltd® offers a limited warranty against manufacturing defects, in compliance with the laws and regulations of each region of distribution. For details about the warranty, visit www.grilleye.com/warranty or send an email to support@grilleye.com

Operation of the device is subject to the following conditions (1) this device may not cause interference, and (2) this device must accept any interference, including interference that may cause undesired operation of this device.

Apple®, the Apple logo, iPad®, iPhone®, and iPod® touch are trademarks of Apple Inc., registered in the U.S. and other countries. App Store is a service mark of Apple Inc. The Bluetooth® word mark and logos are registered trademarks owned by Bluetooth SIG Inc. Android® and Google Play are trademarks of Google Inc. iGrill® and other trademarks and trade names are those of their respective owners.

Product certificates in: www.grilleye.com/certificates

