

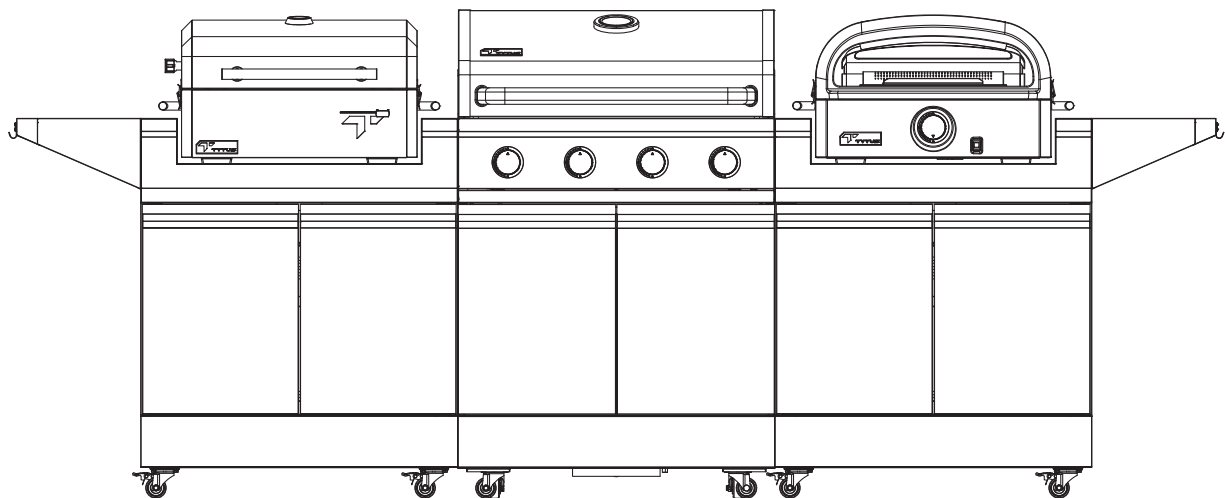

Modular Compatibility



Your Anaheim 4-Burner Gas Grill is part of the TYTUS MODULAR COLLECTION.

To connect your Anaheim 4-Burner Gas Grill to the Grill & Prep Cart and the portable tabletops, follow the instructions below.

1. To install your Grill & Prep Cart on the left side of your Anaheim 4-Burner Gas Grill.
 - Remove the right side shelf from your Grill & Prep Cart, and the left side shelf from your 4-Burner Gas Grill.

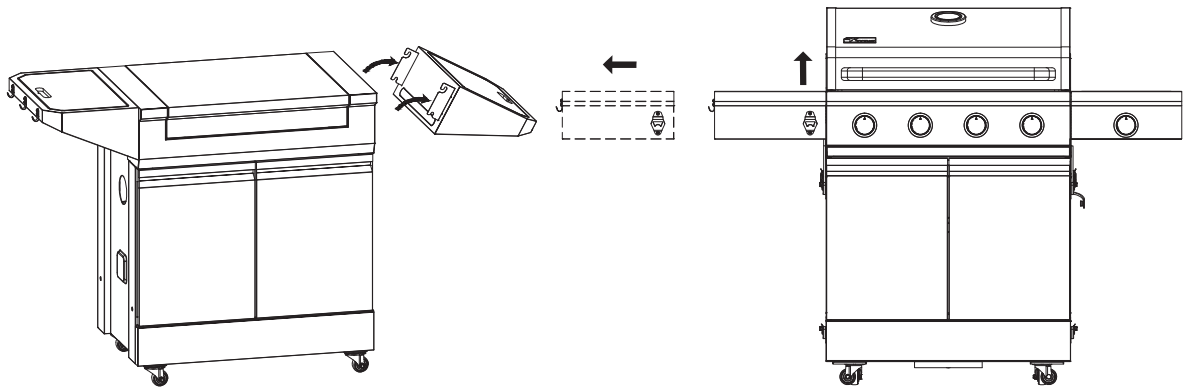

2. To install your Grill & Prep Cart on the right side of your Anaheim 4-Burner Gas Grill.
 - Remove the left side shelf from your Grill & Prep Cart, and the right side shelf from your grill.

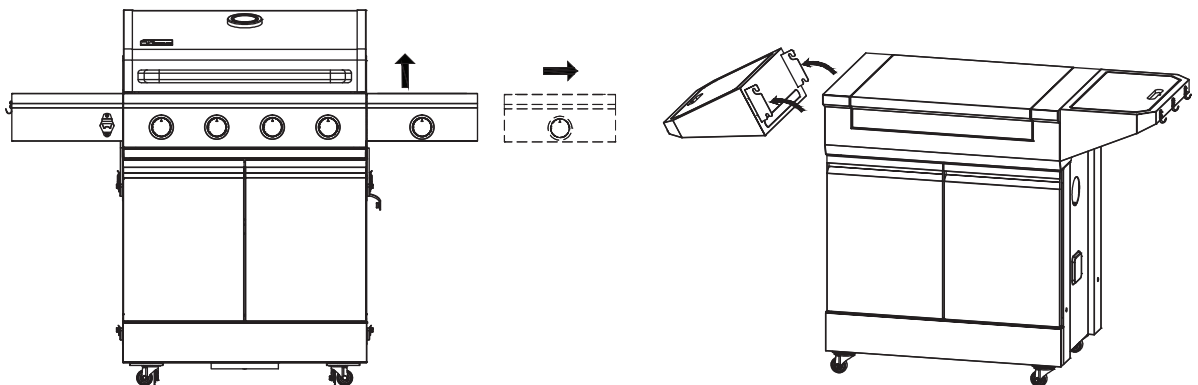



3. With two people, line up the Grill & Prep Cart on the right side of the grill, ensuring the doors are facing the same side, and press the cart onto the brackets attached to the brackets on the burner box of the grill.

NOTE: It is easiest to install a Grill & Prep Cart to the left or right side of the grill when the portable tabletops are momentarily lifted off the Grill & Prep Cart and set aside during assembly.

NOTE: Gas powered units should be placed on the **RIGHT** side of the Anaheim 4-Burner Gas Grill, while electric or charcoal units can be placed on the left or right side of the Anaheim 4-Burner Gas Grill.

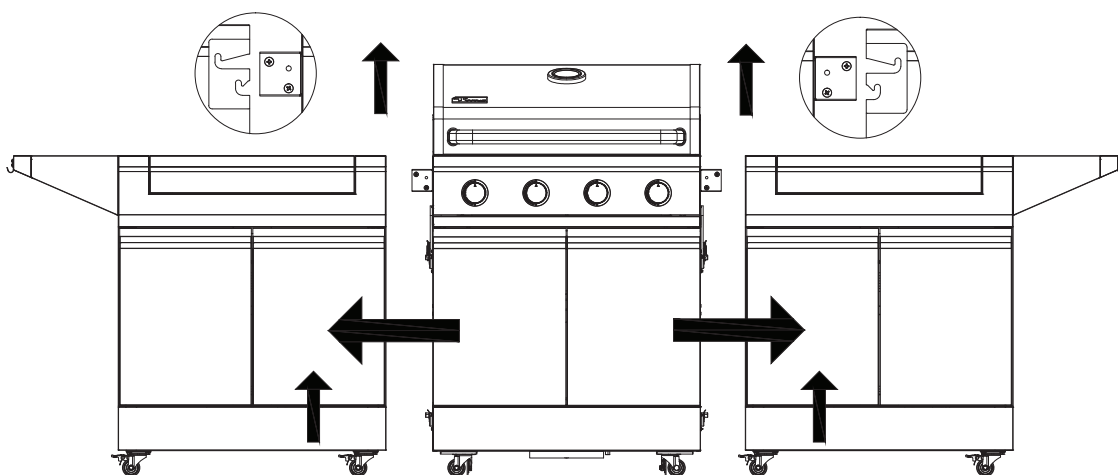

- 4 To secure your Grill & Prep Cart to your Anaheim 4-Burner Gas Grill, use the provided wingnuts to connect the carts at the bottom front. You will need to open your cart doors to do this.

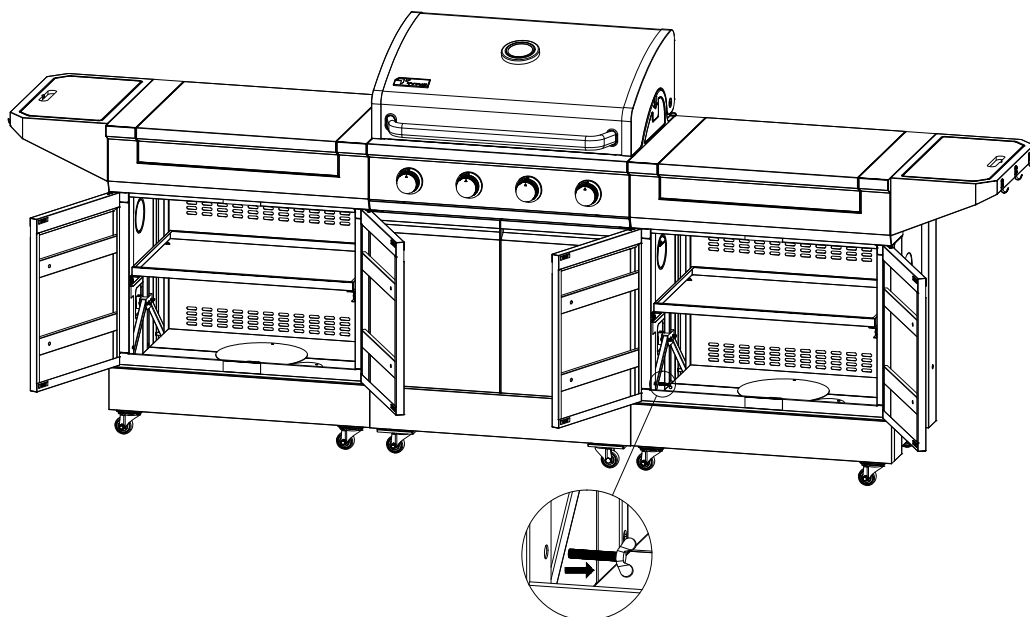

-
5. To connect a gas tabletop to the **RIGHT** Grill & Prep Cart, remove the center prep table.

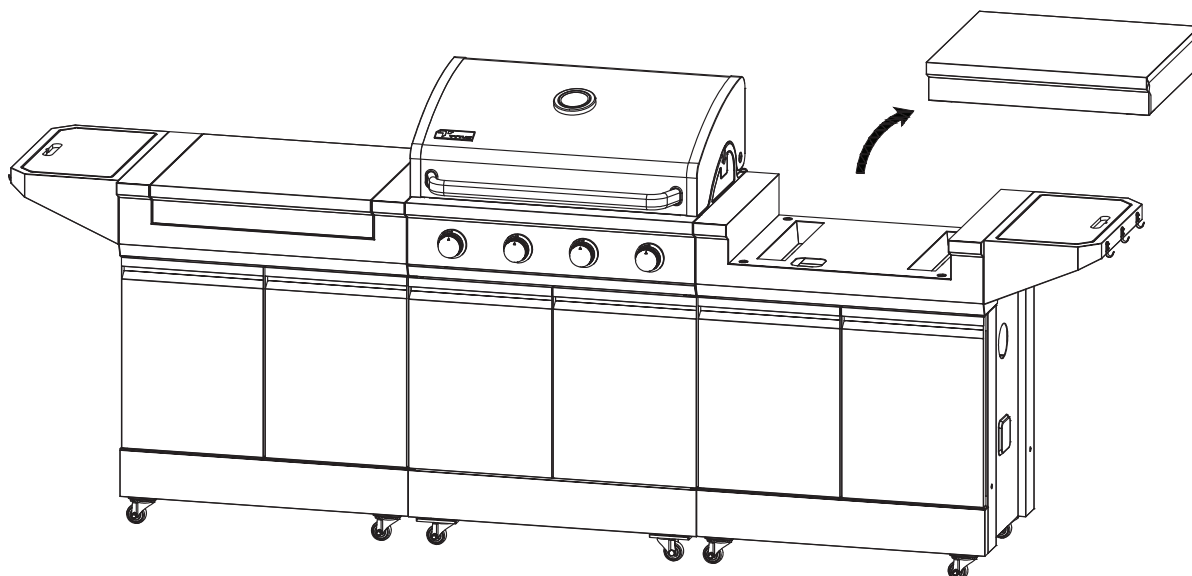

6. Place your portable unit back on your Grill & Prep Cart, threading the gas hose through the center access hole.

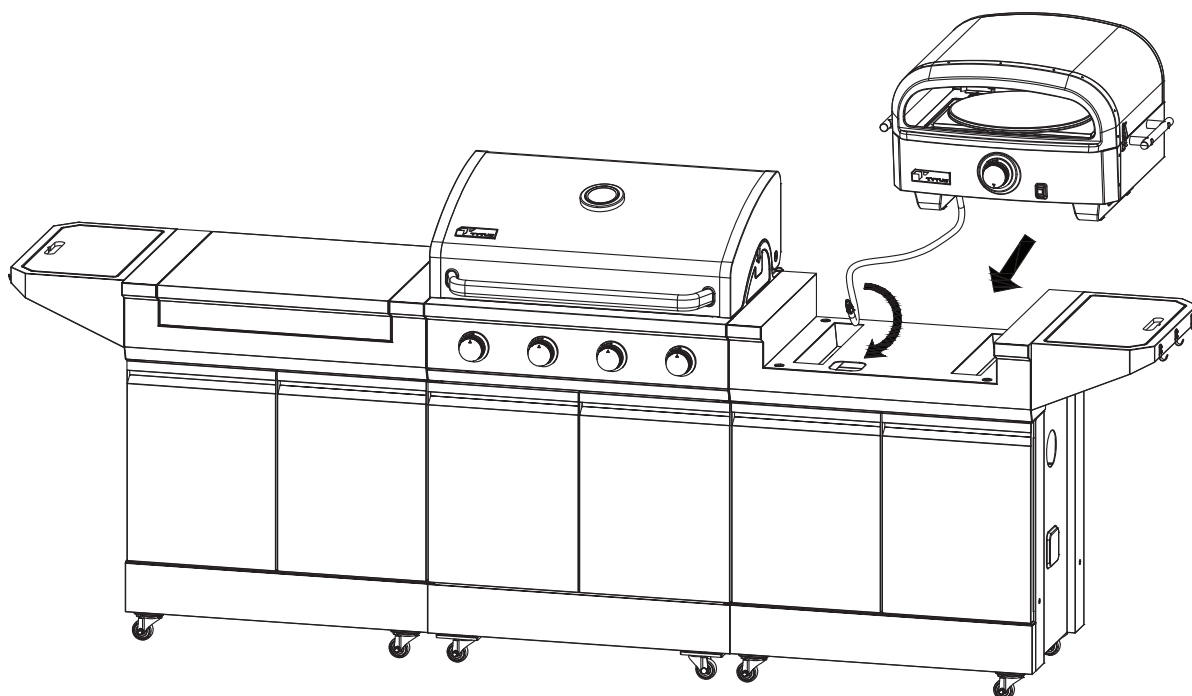



7. Thread the gas hose through the side panels and connect to the "T" gas hose assembly inside the main cart of the Anaheim 4-Burner Gas Grill.

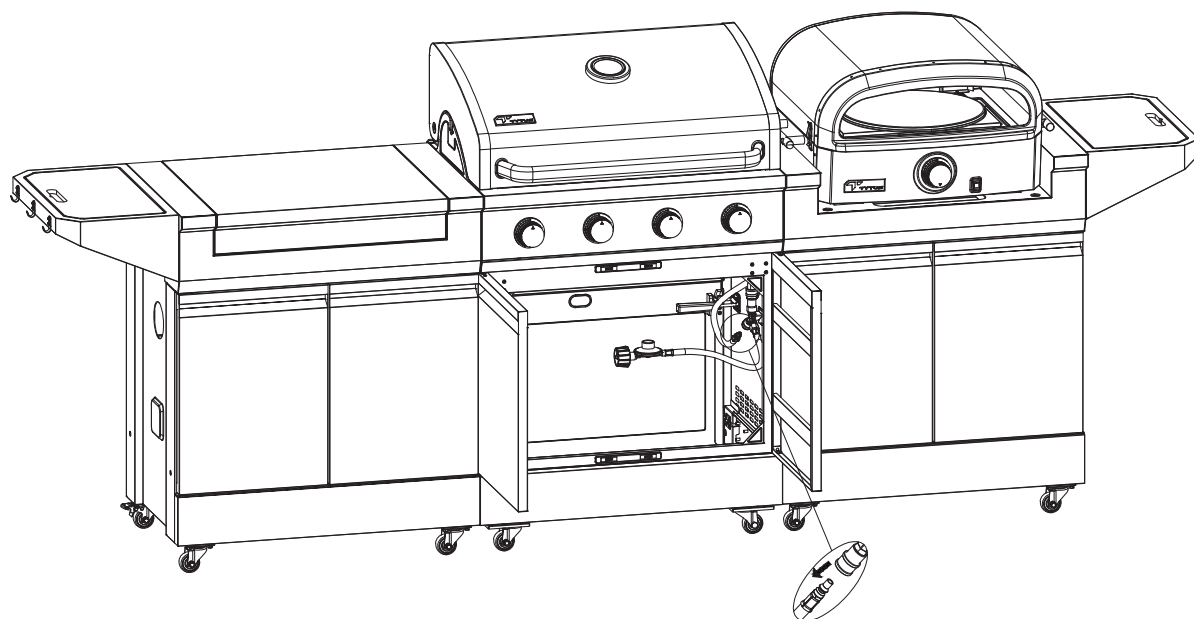
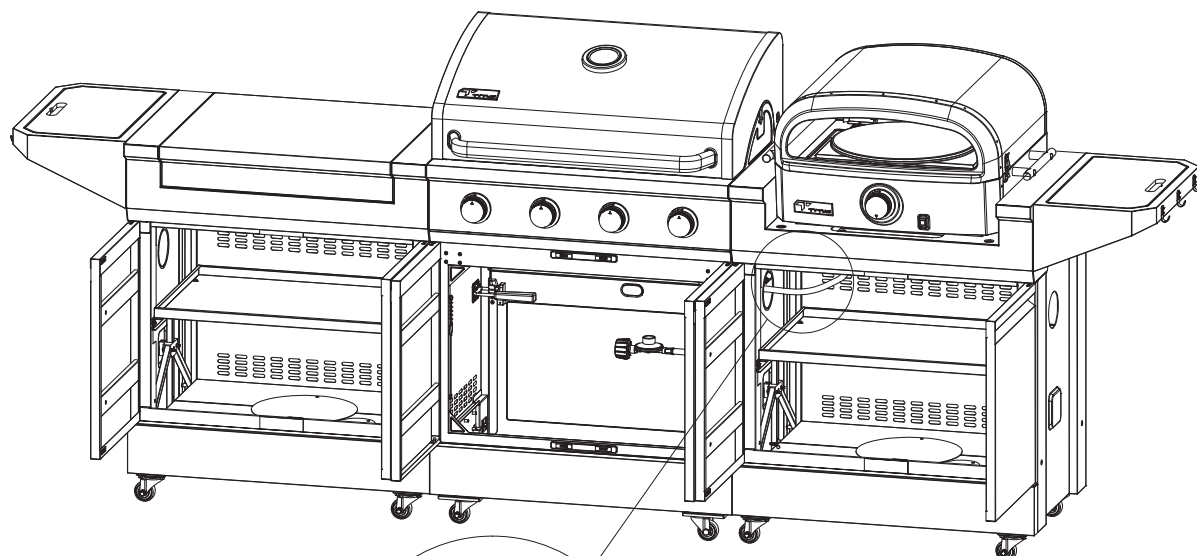

-
8. To connect an electric or charcoal tabletop to the left or right Grill & Prep Cart, remove the center prep table.

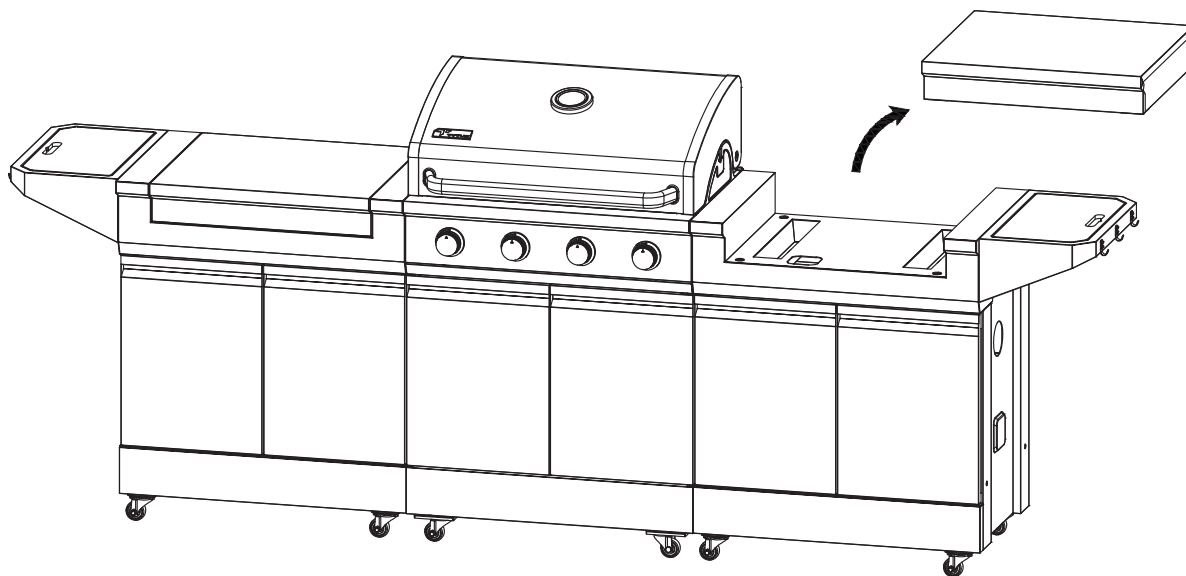

9. Place the tabletop unit into the chassis.

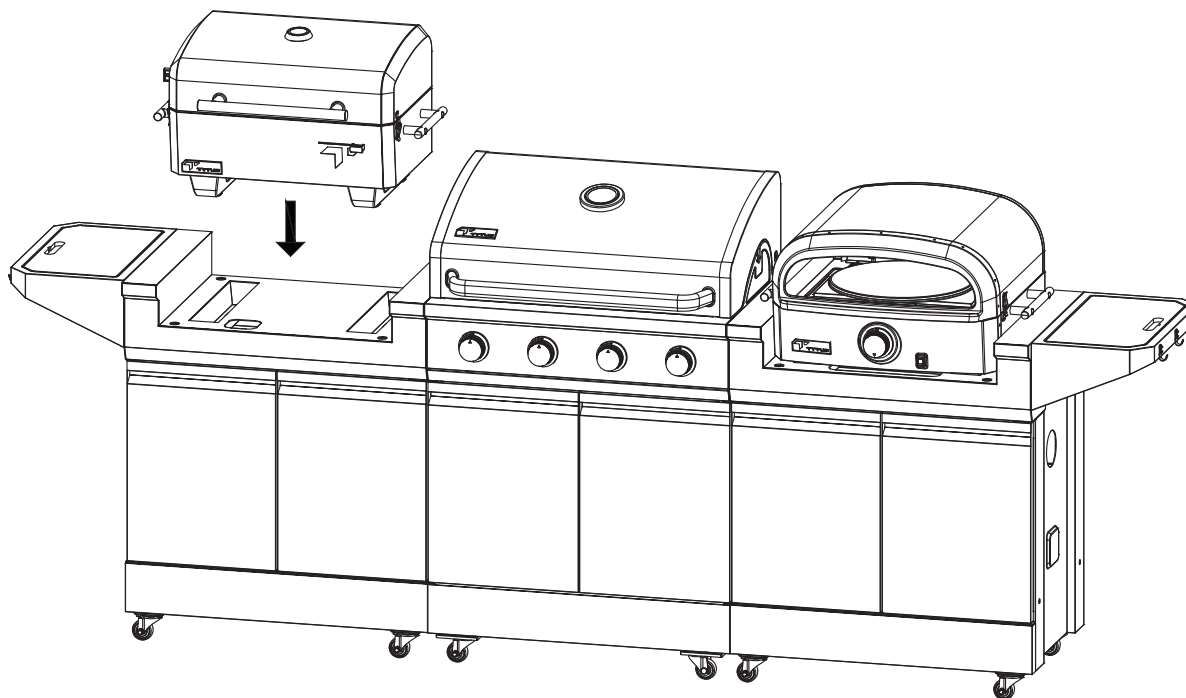



10. Completed Modular Grill.

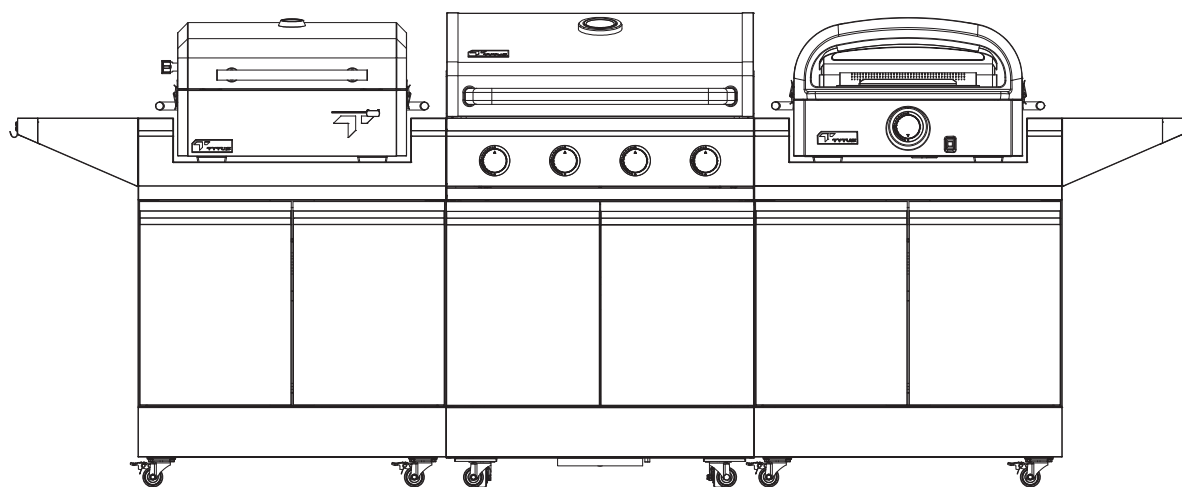



TYTUS and TYTUS Grills are trademarks of TYTUS Grills, LLC.
© 2024 TYTUS Grills, LLC. Designed in the USA. Made in China.
Distributed by TYTUS Grills, LLC, 7151 Metro Blvd, Edina, MN 55439